

Product Image

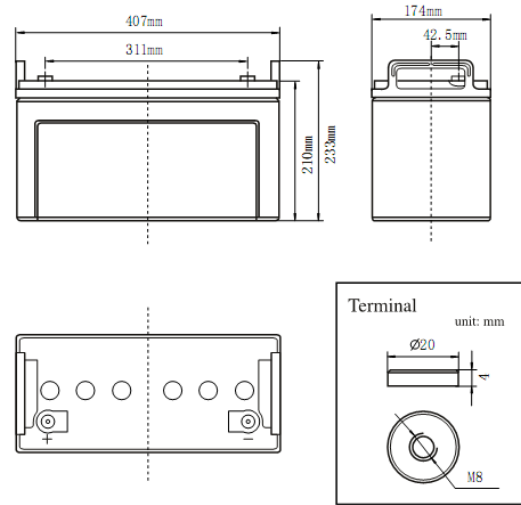

Product Dimensions



Characteristics

| | | |
|---|---------------------------|--|
| Nominal Voltage | | 12V |
| Nominal Capacity (20 hour rate) | | 120Ah |
| Capacity 25°C (77°F) | 10 hour rate (10.8A) | 108Ah |
| | 5 hour rate (19.1A) | 95.5Ah |
| | 1 hour rate (66.5A) | 66.5Ah |
| Internal Resistance | Full Charged Battery 25°C | ≤4.8mΩ |
| Capacity affected by Temperature (10 hour) | 40°C (104°F) | 102% |
| | 25°C (77°F) | 100% |
| | 0°C (32°F) | 85% |
| | -15°C (5°F) | 65% |
| Self-Discharge 25°C (77°F) Capacity | after 3 month storage | 90% |
| | after 6 month storage | 80% |
| | after 12 month storage | 62% |
| Charge (Constant Voltage) 25°C (77°F) | Float | Initial Charging Current Less than 24A Voltage 13.6-13.8V |
| | Cycle | Initial Charging Current Less than 24A Voltage 14.4-14.9V |

Packing

| | | |
|-----------------------|--------------|----------------|
| Battery Dimensions | Length | 407mm |
| | Width | 174mm |
| | Height | 210mm |
| | Total Height | 233mm |
| Box Dimensions | Length | 422mm |
| | Width | 188mm |
| | Height | 289mm |
| Quantity Per Box | | 1 PC per box |
| Net weight Per Cell | | 38.0 kg ± 200g |
| Net weight Per Box | | 38.0kg |
| Gross Weight | | 38.5kg |

Discharge Constant Current per Cell (Amperes at 77°F 25°C)

| F.V/Time | 5min | 10min | 15min | 30min | 45min | 1h | 2h | 3h | 5h | 8h | 10h | 20h |
|----------|-------|-------|-------|-------|-------|------|------|------|------|------|------|------|
| 1.60V | 285.1 | 181.8 | 154.4 | 98.6 | 72.5 | 66.5 | 30.4 | 29.7 | 20.2 | 13.3 | 11.9 | 6.6 |
| 1.65V | 279.9 | 178.5 | 151.6 | 96.8 | 71.2 | 65.3 | 29.9 | 29.2 | 19.8 | 13.1 | 11.7 | 6.48 |
| 1.70V | 274.8 | 175.2 | 148.8 | 95.0 | 69.8 | 64.1 | 29.3 | 28.6 | 19.5 | 12.8 | 11.4 | 6.36 |
| 1.75V | 269.6 | 171.8 | 146.0 | 93.2 | 68.5 | 62.9 | 28.8 | 28.1 | 19.1 | 12.6 | 11.2 | 6.24 |
| 1.80V | 259.2 | 165.2 | 140.4 | 89.6 | 65.9 | 60.5 | 27.6 | 27.0 | 18.4 | 12.1 | 10.8 | 6.00 |

Discharge Constant Power per Cell (Watts at 77°F 25°C)

| F.V/Time | 5min | 10min | 15min | 30min | 45min | 1h | 2h | 3h | 5h | 8h | 10h | 20h |
|----------|-------|-------|-------|-------|-------|-------|------|------|------|------|------|------|
| 1.60V | 548.9 | 349.9 | 297.3 | 189.8 | 139.5 | 128.1 | 58.5 | 57.2 | 38.9 | 25.6 | 22.9 | 12.7 |
| 1.65V | 538.9 | 343.5 | 291.9 | 186.4 | 137.0 | 125.7 | 57.5 | 56.1 | 38.2 | 25.1 | 22.5 | 12.5 |
| 1.70V | 528.9 | 337.2 | 286.5 | 182.9 | 134.4 | 123.4 | 56.4 | 55.1 | 37.5 | 24.7 | 22.0 | 12.2 |
| 1.75V | 518.9 | 330.8 | 281.1 | 179.5 | 131.9 | 121.1 | 55.4 | 54.1 | 36.8 | 24.2 | 21.6 | 12.0 |
| 1.80V | 499.0 | 318.1 | 270.3 | 172.6 | 126.8 | 116.4 | 53.2 | 52.0 | 35.3 | 23.3 | 20.8 | 11.5 |

Note The above data are average values, and can be obtained within 3 charge/discharge cycles. These are not minimum values. Cell and battery designs/specifications are subject to modification without notice. Contact MCA for the latest information.

Performance Characteristics

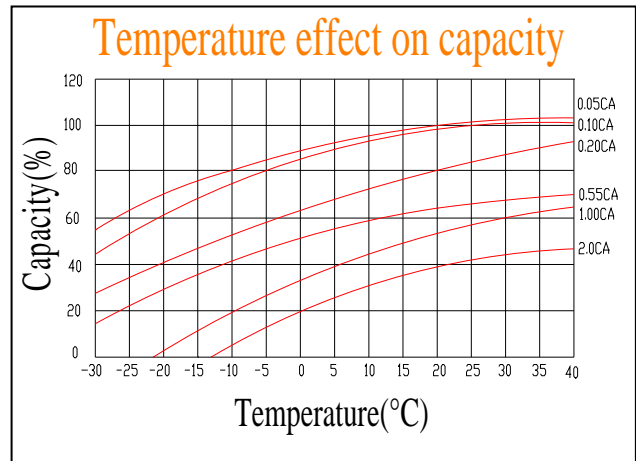
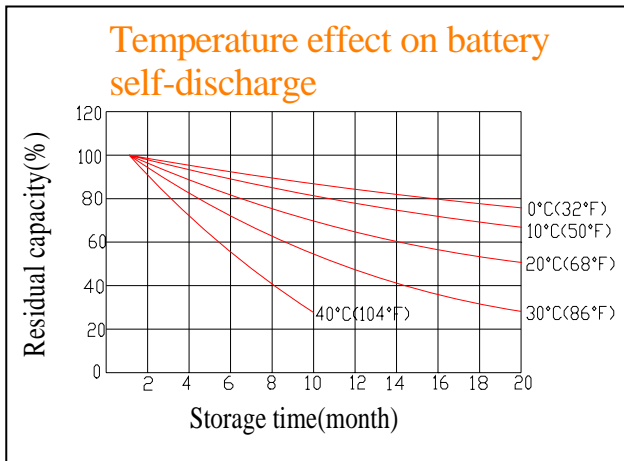
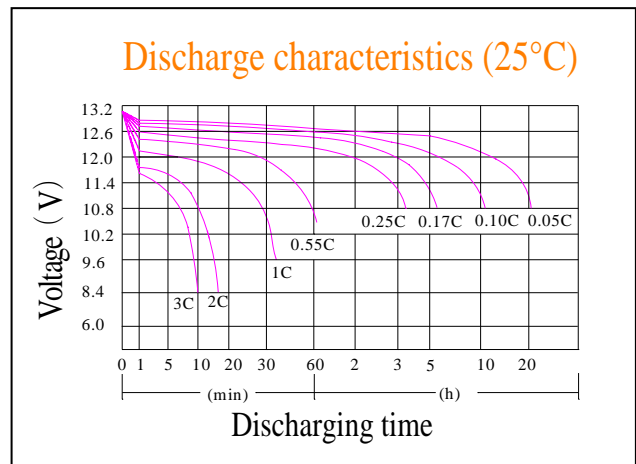
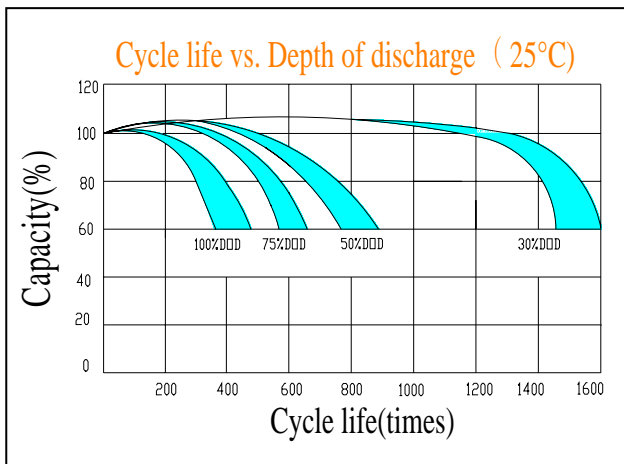
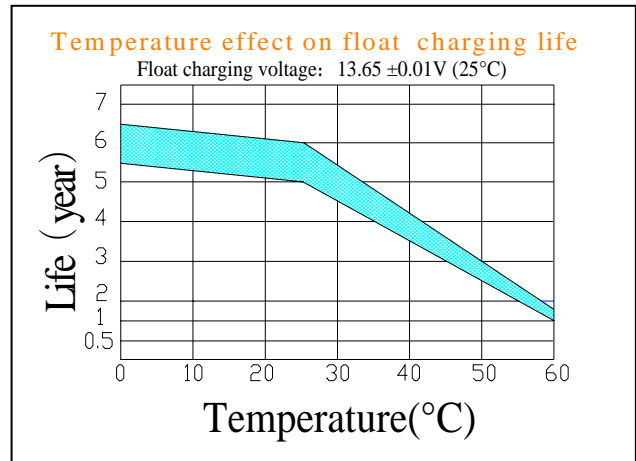
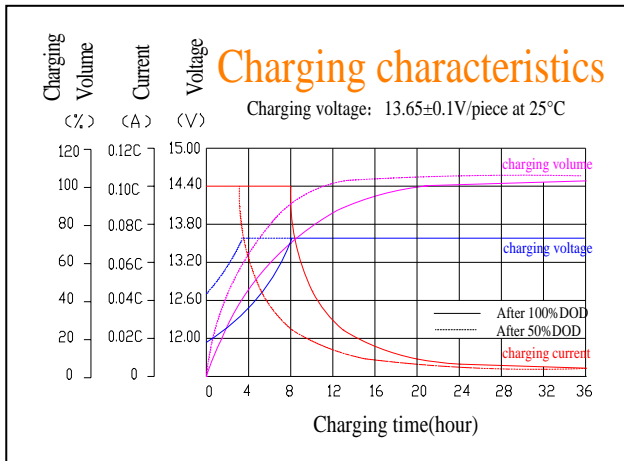

Battery Construction

| Component | Positive plate | Negative plate | Container | Cover | Safety valve | Terminal | Separator | Electrolyte |
|--------------|----------------|----------------|-----------|-------|--------------|----------|------------|---------------|
| Raw material | Lead dioxide | Lead | ABS | ABS | Rubber | Copper | Fiberglass | Sulfuric acid |